

TECHNICAL RIDER: TAKE ME BY THE TONGUE



Company: Hand Me Down

Show: Take Me By The Tongue

Date of the show: Thursday 29th May 2014

MINIMUM STAGE AREA:

Width: 57ft café door to corridor door.

Height: 61ft seats to cyclorama.

STAGE:

- The stage needs to be a clean surface that is good condition and safe for the performance and audience to walk around throughout the performance.

SET:

- Promenade

The set consists of:

- Two rostrums (measuring width: 3ft 5inches, length: 6ft 8inch, height 11inches)
- 12 x chairs (studio chairs)
- 1 x costume rail (location: from green room)
- 2 x trestle tables (location: from studios)
- 4 x microphone stands
- 4 x radio microphones (operated from technical box)

PROPERTIES:

- We will require black drape over the chairs at the back of the auditorium.
- All properties and costume will be placed in a specific place on rail and tables and will be used and returned to specific place throughout the show.

SOUND:

We will require

- 4 x microphone stands
- 4 x radio microphones (operated from technical box)
- Theatre speakers

LIGHTING:

- All bars will be used to wash the space.
- Will require maximum of 4 profiles (with specials).
- There will be areas of light, which will use fresnels (with barn doors).

VIDEO:

- We require a live feed, which will be operated manually throughout the performance (placed near the microphone station when not in use – see set diagram below) – a performer will operate and a second performer will cable the live feed equipment.
- Cyclorama will be projected on using the live feed and other pre recorded footage operated through hanging projector.
- Projector will be used in the technical box and operated using QLAB.
- The hanging placement of the projector will need to be projected central in the performance space as it is required to shoot over a performers head of 6'1" standing.
- Mac projector adapter cable will be provided.

OPERATION:

- Will require a person to operate sound/video on QLAB.
- Performers will operate haze on the night.
- Sound, light and projection will be operated from same position.
- Production/Stage Manager will operate light.

POWER:

- We will need plug in the performance space for the haze machine. If it is on show to the audience, black would be preferable.
- All radio microphones will be used only in the performance space but will have to be plugged in stage left.

TIME IN VENUE:

- Get in 9am.
- Show will begin at 7.30pm.
- Show running time approximately 60 minutes.
- Get out by 10pm.

(Day schedule will be sent to dpage@lincoln.ac.uk no later than the 22nd May)

SECURE STORAGE:

Hand Me Down Theatre Company will be using their own MacBook Pro during their time in the venue.

If you need any more information just contact Andrew Tinley on andrewtinley2012@hotmail.com/
hmdtheatre@gmail.com

SET DIAGRAMS/IMAGES.

cyC. wide screen projection

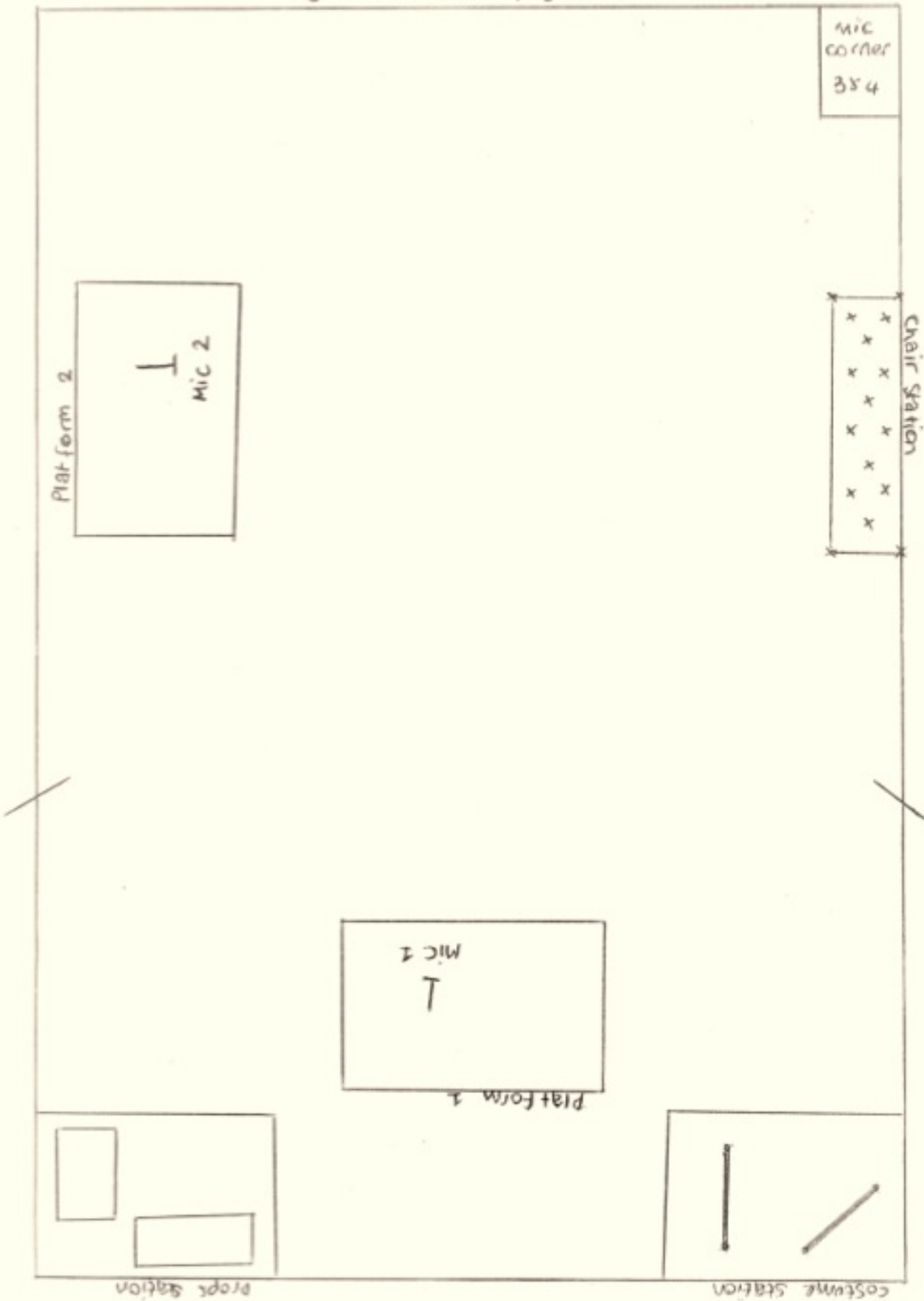

(Set diagram with each areas stated – view: from tech box/birds eye view)

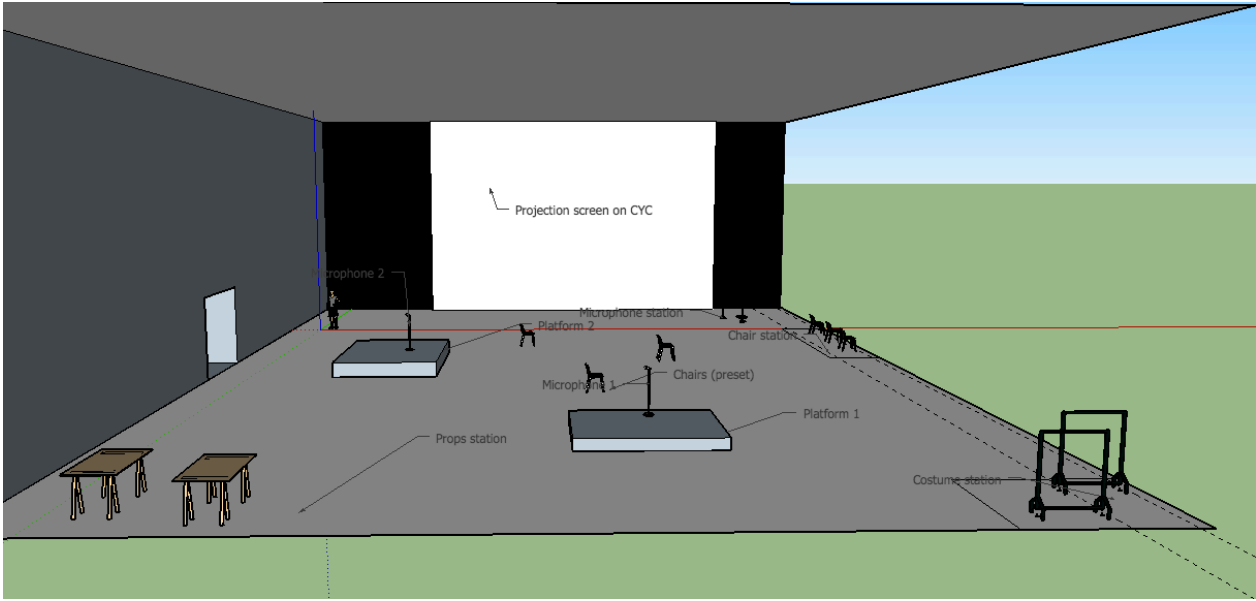

(3D set design view: from tech box)

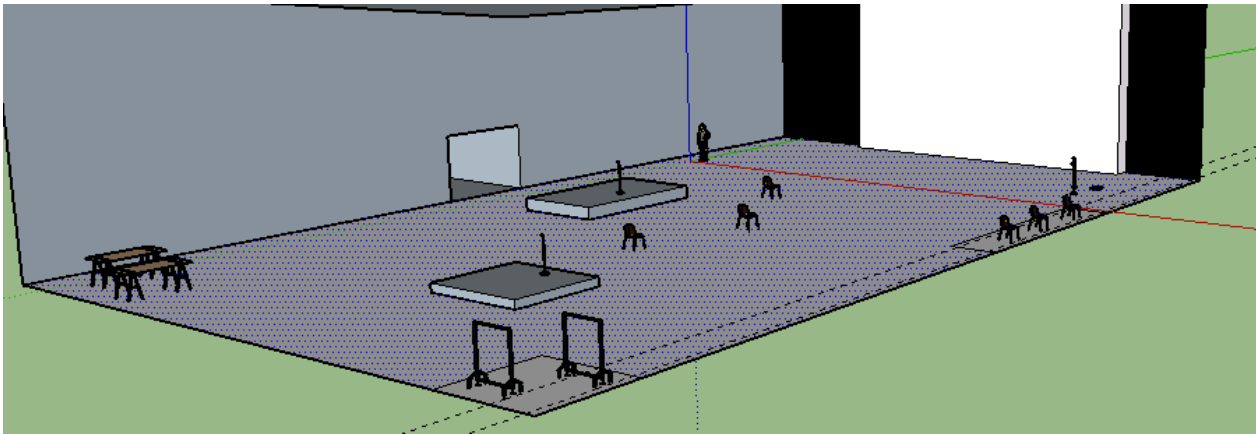

(3D set design view)

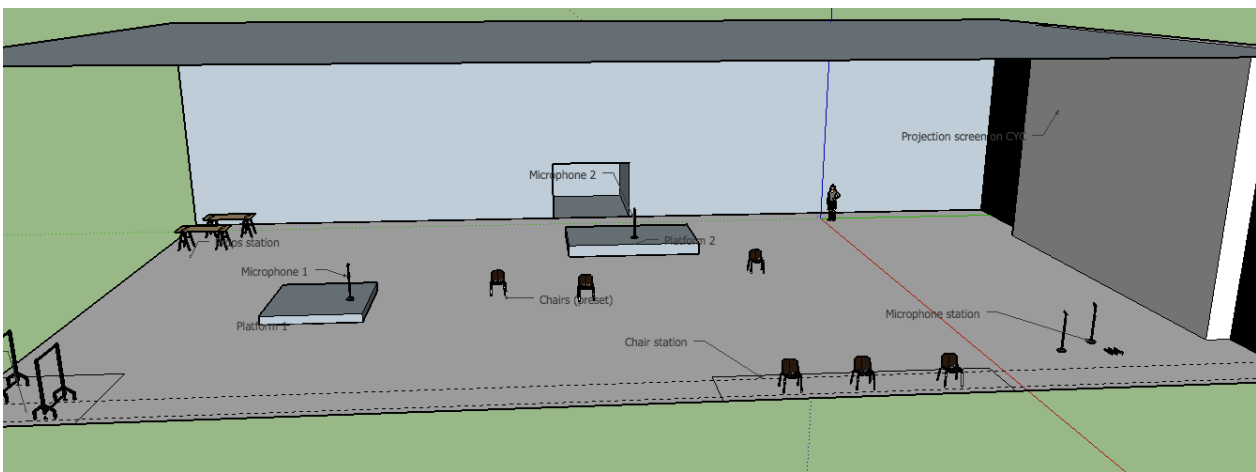

(3D set design view: from zing entrance doors)

